

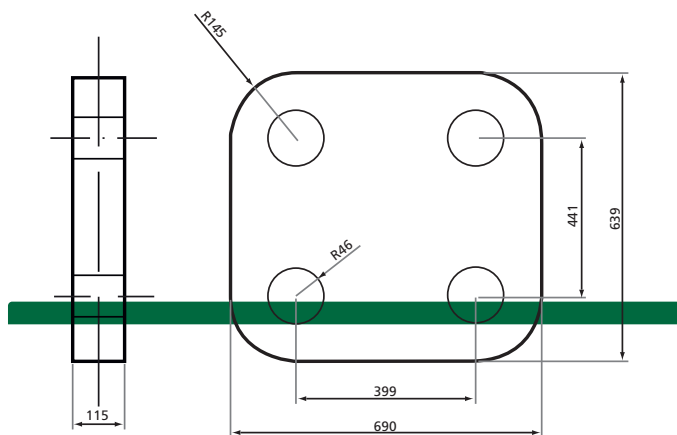

TOWING AND MOORING EQUIPMENT

# QUADPLATE

GRADE 3



WLL: 85T – BL: 452T  
Weight: 415 kgs

**Note:** The measurements in tables may vary between different models. Sotra Anchor & Chain AS can not be hold responsible for any deviate between tables and delivered equipment.

**SOTRA ANCHOR & CHAIN AS**  
Gamle Vindenesvegen 11  
5363 Ågotnes, Norway

Tel.: (+47) 56 32 68 50  
E-mail: [sales@sotra.net](mailto:sales@sotra.net)  
Web: [www.sotra.net](http://www.sotra.net)

