

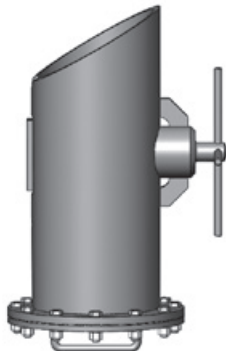

TOWING AND MOORING EQUIPMENT

END FASTENING FOR ANCHOR- CHAIN CABLE

DIN81860

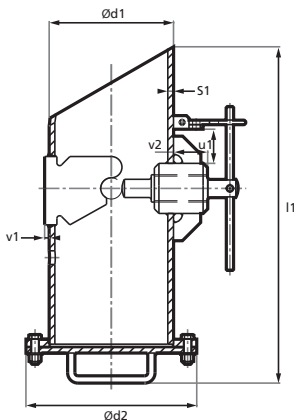

Anchor Chain dia.	Ød1	Ød2	s1	l1	u1	v1	v2
mm	mm	mm	mm	mm	mm	mm	mm
36-46	273	375	12.5	735	75	10	75
48-56	323.9	440	14.2	835	95	12	90
58-68	406.4	540	16	995	110	14	95
70-81	508	645	17.5	1245	105	15	100
84-92	508	645	17.5	1245	130	15	150
95-105	610	754	20	1430	130	18	150
107-114	610	754	20	1430	170	18	185
117-127	711	856	22.2	1615	170	20	185
130-137	813	958	22.2	1790	170	20	185
142-152	914	1060	25	1970	190	22	200

Note: The measurements in tables may vary between different models. Sotra Anchor & Chain AS can not be hold responsible for any deviate between tables and delivered equipment.