

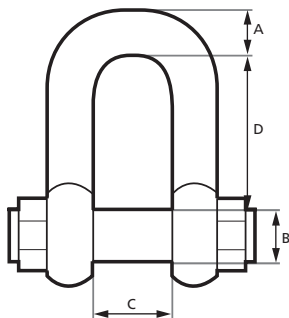

## D-TYPE SHACKLE



WLL	A		B		C	D	Weight
Tonnes	Inches	mm	mm	mm	mm	mm	Kgs
2	1/2	13	16	22	43	0,3	
3,25	5/8	16	19	27	51	0,6	
4,75	3/4	19	22	31	59	1,0	
6,5	7/8	22	25	36	73	1,460	
8,5	1	25	28	43	85	2,6	
9,5	1 1/8	28	32	47	90	3,3	
12	1 1/4	32	35	51	94	4,7	
13,5	1 3/8	35	38	57	115	6,2	
17	1 1/2	38	42	60	127	7,6	
25	1 3/4	45	50	74	149	12,8	
35	2	50	57	83	171	18,1	
42,5	2 1/4	57	65	95	190	27,8	
55	2 1/2	65	70	105	203	35	
85	3	75	82	127	230	60	
120	3 1/2	89	95	146	267	93	
150	4	102	108	165	400	145	
200	4 3/8	120	130	175	500	180	
250	4 3/4	125	140	200	540	225	
300	5 1/8	135	150	200	600	305	
400	5 7/8	165	175	225	650	540	
500	6 3/4	175	185	250	700	580	
600	7 1/2	195	205	275	700	850	
700	7 7/8	205	215	300	730	920	
800	8 1/4	210	220	300	730	990	
900	8 21/32	220	230	320	750	1165	
1000	9	230	240	340	750	1315	
1200	9 27/32	250	280	400	840	1700	
1500	10 1/4	260	325	460	840	2500	

Note: The measurements in tables may vary between different models. Sotra Anchor & Chain AS can not be hold responsible for any deviate between tables and delivered equipment.