

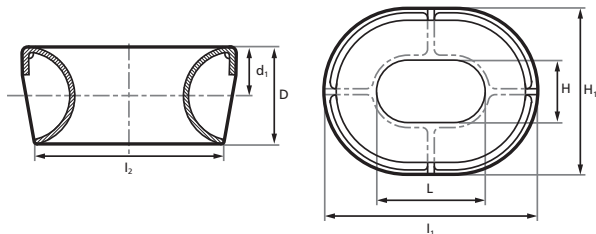

TOWING AND MOORING EQUIPMENT

BULWARK CHOCK

ISO 13729



Nominal size	l1	l2	H1	d1	SWL	Calculated weight
LxHxD	mm	mm	mm	mm	t	Kgs
250 × 200 × 214	516	441	466	108	23	49
300 × 250 × 286	638	554	588	144	43	100
350 × 250 × 333	736	646	636	168	56	141
400 × 250 × 381	834	736	684	192	70	184
450 × 250 × 381	884	786	684	192	72	194
500 × 250 × 381	934	836	684	192	78	202
400 × 250 × 428	882	778	732	216	90	264
450 × 250 × 428	932	828	732	216	93	276
500 × 250 × 428	982	878	732	216	95	288
500 × 400 × 428	982	878	882	216	91	311
500 × 250 × 525A	1078	976	828	264	117	379
500 × 400 × 525A	1078	978	978	264	118	408
500 × 250 × 525B	1078	976	828	264	144	405
500 × 400 × 525B	1078	978	978	264	141	442

Note: The measurements in tables may vary between different models. Sotra Anchor & Chain AS can not be hold responsible for any deviate between tables and delivered equipment.